

Ultra Quiet SR

High Performance Sound Rated Floor System

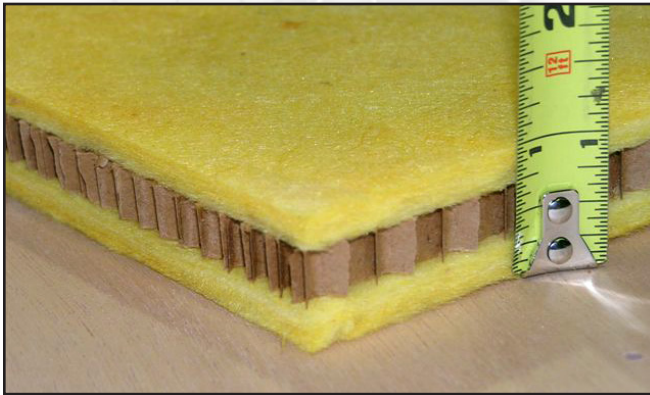

Kinetics Ultra Quiet SR Floorboard is a high performance continuous underlayment material which substantially reduces impact noise transmission through hard surface floor systems. Lab Ratings of IIC (Impact Insulation Class) approaching 60 are possible in typical applications, compared with IIC-25 to 34 with conventional construction.

Ultra Quiet SR Floorboard is a new concept in the control of noise in condominiums, apartments, multi-family dwellings, commercial buildings, and other areas where footfall and impact noise can be the cause of occupant complaints.

Ultra Quiet SR Floorboard is a 1 inch (25 mm) thick composite of high density molded glass fibers separated by a rigid phenolic-treated honeycomb core.

Application

Many occupants have a preference for hard surface floors such as ceramic tile, quarry tile, marble, hardwood flooring, engineered floors, or vinyl tile. Without carpeting to cushion footfalls, impact noise will be heard clearly in the occupied spaces below.

Many localities have adopted building codes which require minimum IIC and STC ratings for floor/ceiling systems. An IIC of 50 or less will result in disturbing impact sounds below. With an IIC of 50 to 60, certain

sounds may be audible in the spaces below. Acousticians familiar with noise issues in high end condominium buildings often recommend a lab tested assembly with ratings in the 55 to 60 range to minimize occupant complaints.

Ultra Quiet SR Floorboard is used where more typical typical 1/4 to 1/2 inch sound control mats do not provide the necessary sound reduction. This 1-inch thick resilient layer dramatically improves impact (IIC) noise ratings through the floor assembly while also increasing the STC rating for airborne noise.

For use with either wood frame or concrete structural floors, Ultra Quiet SR Floorboard can be installed with a reinforced mortar bed, gypsum concrete, or a poured concrete slab.

Features

- Greater noise control than typical 1/4 to 1/2 inch sound control mats
- Withstands live loads up to 1000 psf
- Maintains strength even when wet
- Cuts easily with standard construction knife
- Very lightweight, easy to hand and install
- Approved for use with gypsum concrete, standard concrete, and built up wood floors
- Combines high resilience and sound absorption in a single layer
- Does not shrink or curl like nylon fiber products

Technical Data

- Size: 4' x 8'
- Thickness: 1"
- Nominal Weight: 16 lbs./sheet
- Approved for use with 1-1/2" gypsum concrete, 2000 psi minimum with metal lath reinforcing. See installation guidelines.

STC/IIC Sound Test Data

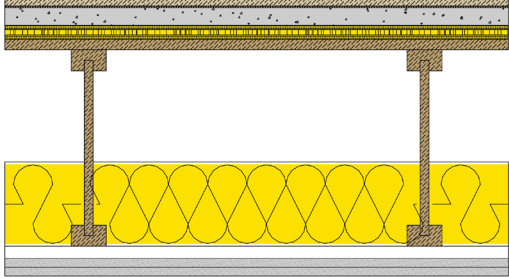
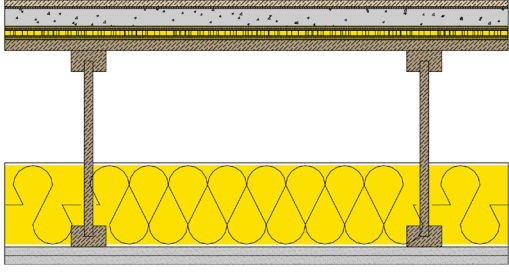
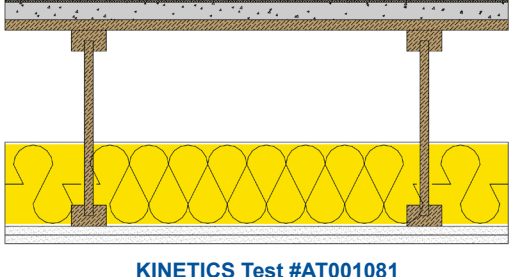
<p>Hardwood Floor with 1/8" Pad 1-1/4" Gypsum Concrete 1" KINETICS™ Ultra Quiet SR Floorboard 3/4" Plywood 14" I-Joist 6" Fiberglass Insulation Resilient Channel 2 Layers of 5/8" Gypsum Board</p>	<p>STC 54 IIC 59</p>	 <p>KINETICS Test #AT001077</p>
<p>Hardwood Floor with 1/8" Pad 1-1/4" Gypsum Concrete 1" KINETICS™ Ultra Quiet SR Floorboard 3/4" Plywood 14" I-Joist 6" Fiberglass Insulation 2 Layers of 5/8" Gypsum Board No Resilient Channel</p>	<p>STC 53 IIC 51</p>	 <p>KINETICS Test #AT001078</p>
<p>Hardwood Floor with 1/8" Pad 1-1/4" Gypsum Concrete 3/4" Plywood 14" I-Joist 6" Fiberglass Insulation 2 Layers of 5/8" Gypsum Board No Resilient Channel</p>	<p>STC 51 IIC 39</p>	 <p>KINETICS Test #AT001081</p>

Visit www.kineticsnoise.com/arch/tests/ultraquiet.html for complete UltraQuiet STC/IIC Sound test data

Typical Edge Detail

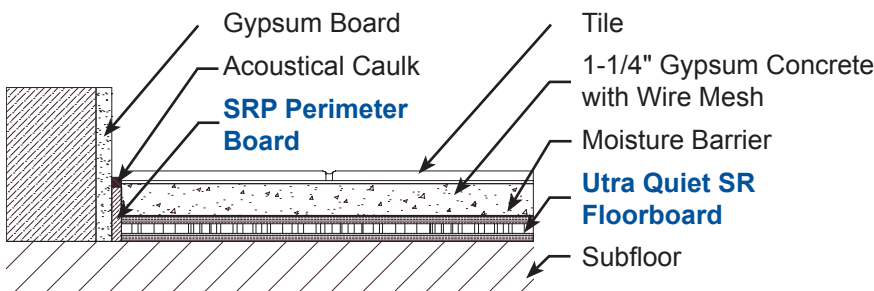

kineticsnoise.com
sales@kineticsnoise.com
 1-800-959-1229