

1

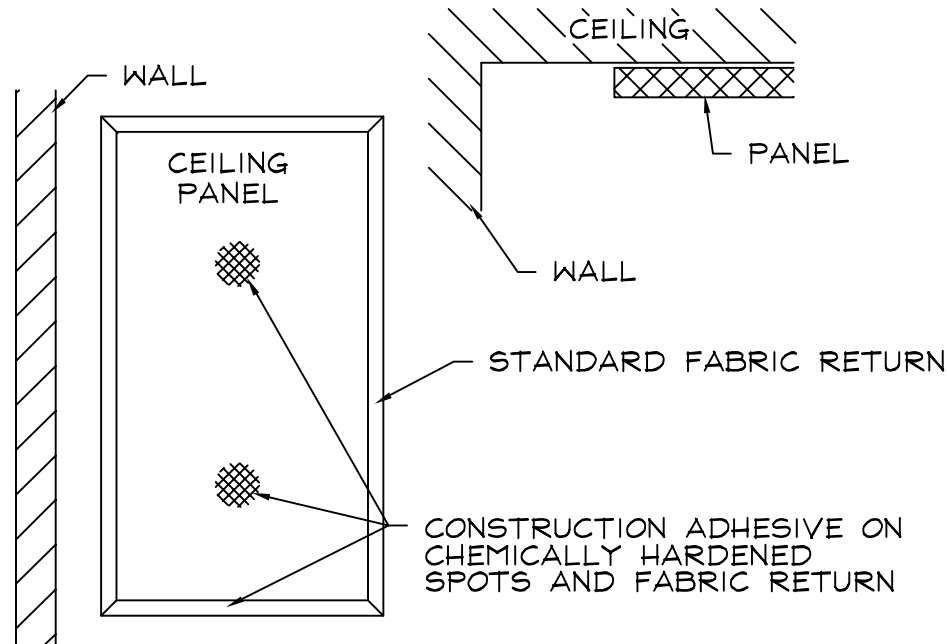

2

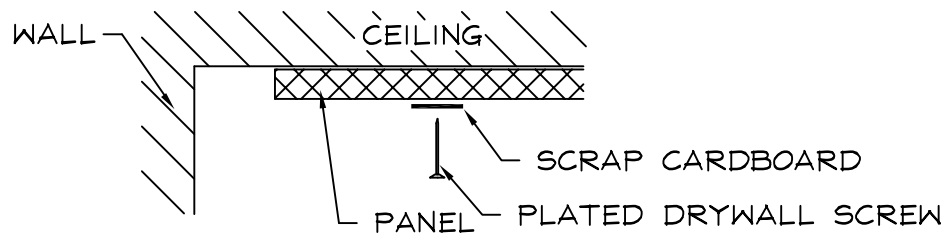

TO SUPPORT PANELS WHILE CONSTRUCTION ADHESIVE CURES, USE PLATED DRYWALL SCREWS AND SCRAP PIECES OF CARDBOARD (2" x 2" NOM.) TO ATTACH PANELS TO THE CEILING. (NOTE: DO NOT USE BLACK SCREWS OR FABRIC MAY BE SOILED.) USING CARDBOARD AS A WASHER, SCREW DIRECTLY THROUGH THE PANEL AND INTO THE CEILING. THE CARDBOARD WILL PREVENT THE SCREW HEAD FROM TOUCHING THE PANEL FABRIC. AFTER THE ADHESIVE HAS CURED (2 DAYS) REMOVE THE SCREWS. SMOOTH OVER THE SCREW HOLE IN THE FABRIC FACING WITH A CLEAN HAND OR GLOVE AND THE HOLE SHOULD DISAPPEAR. PRE-TEST FABRIC PRIOR TO SCREWING THROUGH FACE TO ENSURE THE HOLE DIAPPEARS.



TITLE  
CEILING PANEL INSTALLATION  
WITHOUT BUTTED SEAMS

LAST DATE  
REVISED  
4/23/09

DRAWN BY  
JAA

DRAWING NO.  
INSTAL24

T-DWG