

# INSTALLATION INSTRUCTIONS FOR SPLIT INERTIA BASE

1. Place inertia base frame sections on a flat surface in its operating location. Join base sections and bolt together securely with hardware provided.
2. Weld around splice plates, using  $\frac{5}{32}$ " weld.

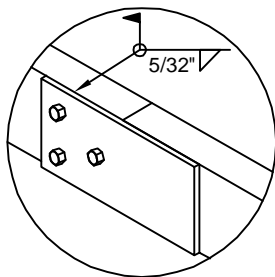

3. Wire wrap or tack weld included rebar sections to join rebar across splice.
4. Continue with CIB installation instructions.

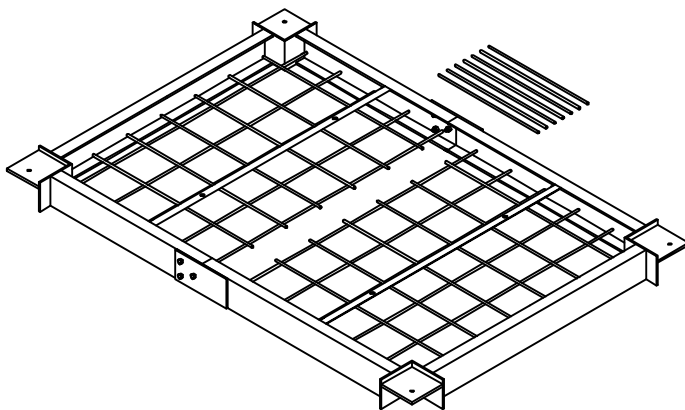
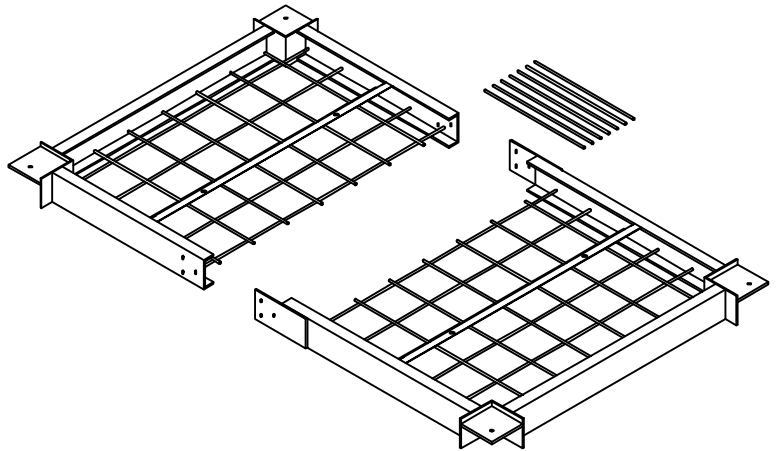