

$\frac{3}{8}$ -16 UNC x 2
HEX HD. BOLT

$\frac{3}{8}$ -16 UNC
HEX JAM NUT

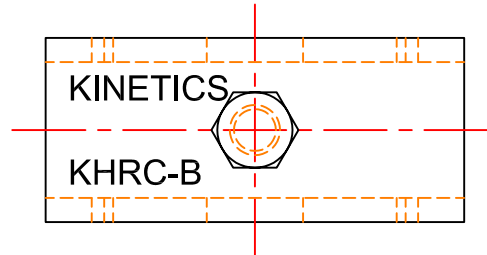

RANGE OF STIFFENER ANGLES

AISC STANDARD	METRIC
1 x 1 x 1/8	25 x 25 x 3
1-1/4 x 1-1/4 x 1/4	30 x 30 x 5
1-1/2 x 1-1/2 x 1/4	40 x 40 x 6

RANGE OF HANGER RODS

INCH STANDARD	METRIC STANDARD
3/8	M10
1/2	M12
5/8	M16
3/4	M20
7/8	M22
1	M24
1-1/8	M30