

NOISE CONTROL RESILIENT CEILING
WAVE HANGER
Patent No. 8,549,809
 INSTALLATION GUIDELINES

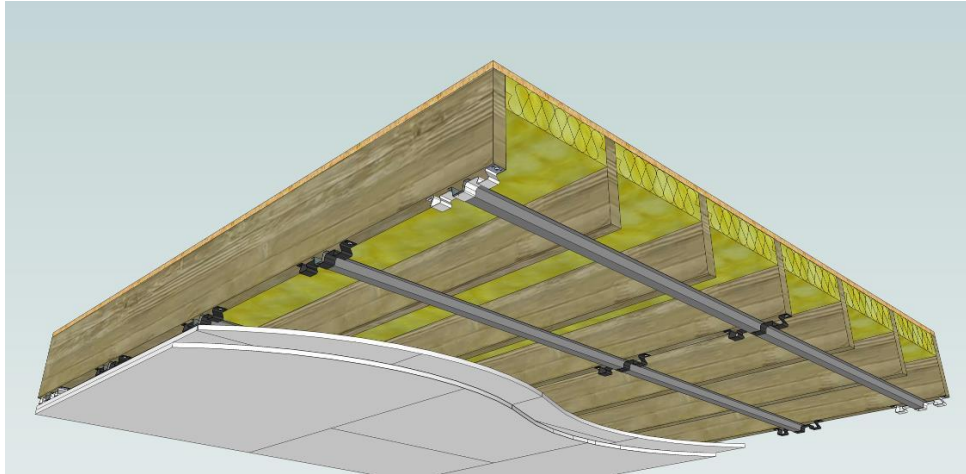

Suggested Materials and Tools:

- WAVE 44 (Black) and WAVE 22 (Silver)
- Kinetics CPT (Ceiling Perimeter Tape)
- 0.875" tall 20-ga (minimum) drywall furring channel
- No. 18 SWG double strand galvanized steel tie wires
- 0.625" Type X (Type C for ESR-3207) Drywall
- No. 10 x 1-1/2-in. Round Washer Recex Lo Root Lubricized Screws (Fastenal #139966, supplied by KINETICS with WAVE Hanger order)
- Hardened Phillips-Square Combo Bit #PSD2-2 (available at local hardware store or supply house)
- No. 7x2-in. fine thread drywall screws
- Non-hardening, resilient acoustical caulk
- Powered screwdriver
- Pliers

Typical Perimeter Details
 (each direction)

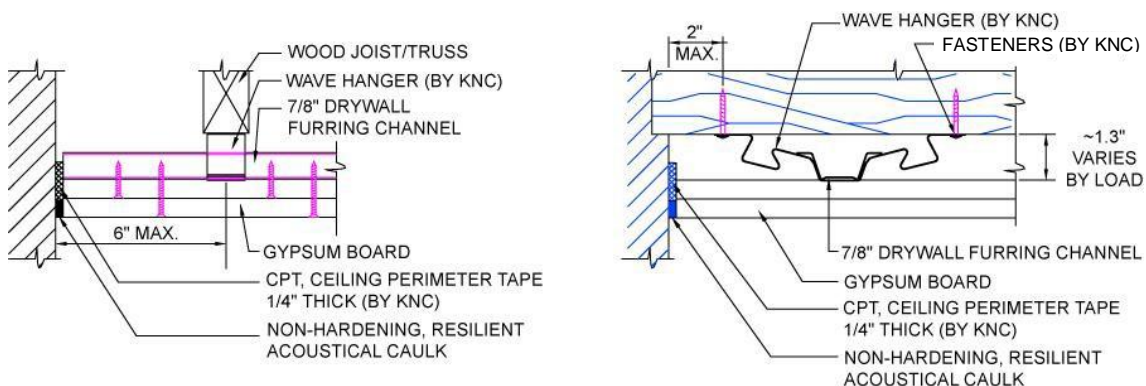

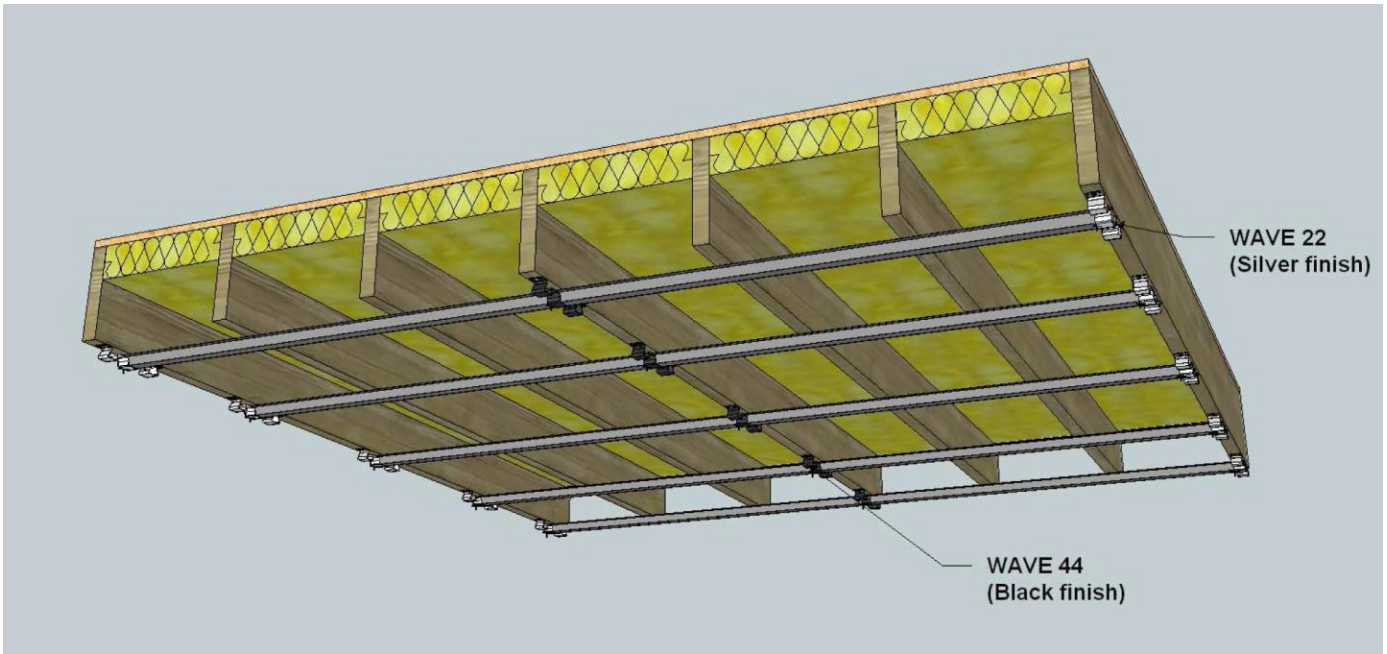

Step 8: Completed Ceiling with *WAVE* Hanger 22 (silver finish) in the corners and areas carrying less than 4-1/2 sq. ft. *WAVE* Hanger 44 (black finish) everywhere else.

Notes on Drywall Installation:

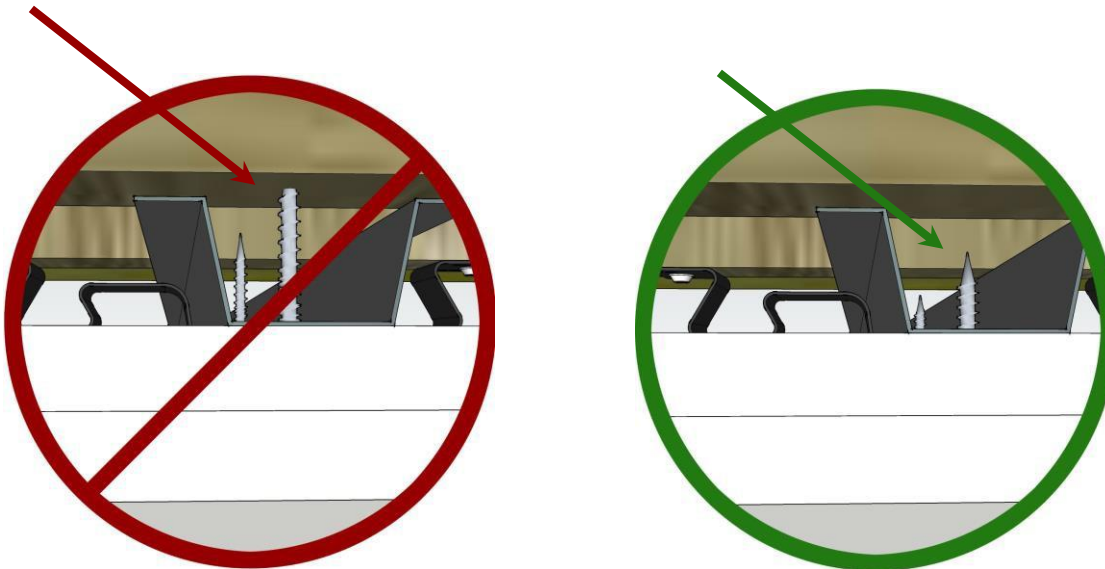

Do not screw drywall to joists

Install drywall to drywall furring channel using accepted practices for drywall installation and for meeting local building code requirements.

NOISE CONTROL RESILIENT CEILING
WAVE HANGER

Patent No. 8,549,809

Appendix A: Seismic Installation

Seismic Zone A:

- No special installation needed

Seismic Zones B-F:

- Individual pieces of drywall furring channel shall be no more than 14 ft long.
- Install one Seismic Restraint Plate (Figure 1) per individual piece of drywall furring channel.
- The Seismic Restraint Plate shall be placed outside of *WAVE* Hanger and attached to the drywall furring channel with #10 -3/4" long hex head self-drilling screws.
- Holes are located on the Seismic Restraint Plate so that a screw will be on either side of the *WAVE* Hanger.
- Do not fasten Seismic Restraint Plate through *WAVE* Hanger

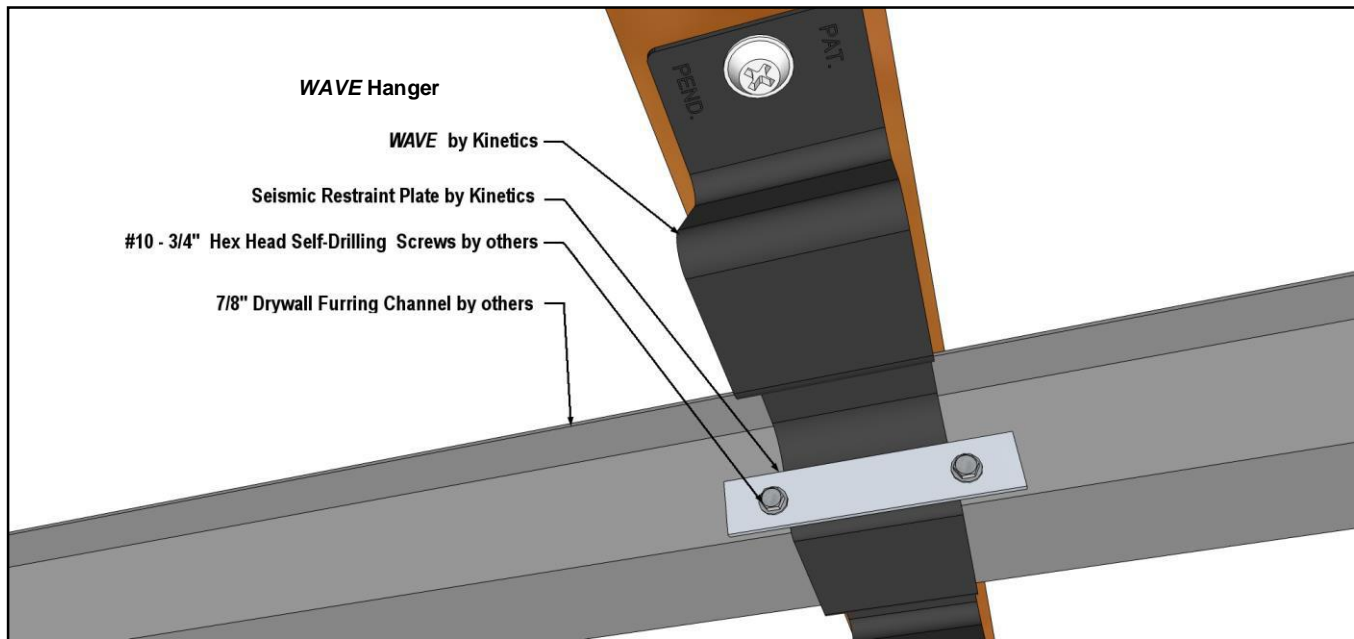

Figure 1: Seismic Restraint Plate Installation for *WAVE* Hanger in seismic zones B-F

Disclaimer

These installation guidelines represent generally accepted procedures for successful installation of Kinetics Noise Control WAVE Hanger. These suggestions may be followed, modified, or rejected by the owner, engineer, contractor, and/or their respective representative(s) since they, not Kinetics Noise Control, are responsible for planning and executing procedures appropriate to a specific application. Kinetics Noise Control reserves the right to alter these suggestions and encourages contact with the factory or its representatives to review any possible modification to these installation guidelines prior to commencing installation.