

- NOTES:
1. WALL TRACK OR ANY ATTACHMENT TO THE WALL IS NOT PERMISSIBLE IN THE CONSTRUCTION OF AN ISOLATED CEILING.

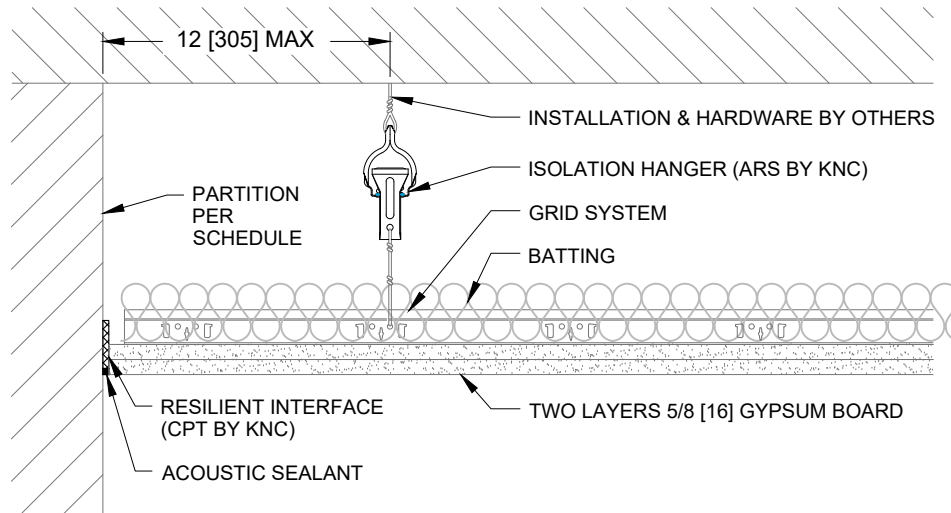

- NOTES:
1. WALL TRACK OR ANY ATTACHMENT TO THE WALL IS NOT PERMISSIBLE IN THE CONSTRUCTION OF AN ISOLATED CEILING.
 2. REFER TO GRID MANUFACTURERS GUIDELINES FOR RECOMMENDED INSET AT PERIMETER.

DIMENSION FORMAT: IN [mm]

SCALE: 1-1/2" = 1'-0"