



System: CATM

KINETICS® Solutions

Outdoor Air-Cooled Chiller Acoustical Barrier Wall System



Model STL-4 Panel



Model VAL & VAR Louvers



NOISEBLOCK™ Doors

The Situation

The noise source is an outdoor Air-Cooled Chiller. Noise is propagating into critical areas: screw compressors (on the bottom of the unit) generate mid/hi frequency noise; Up-blast fans (on the top) generate low frequency noise.

Issue

A common but inadequate attempt to control the noise is to wrap the compressors with mass-loaded vinyl jackets. This rarely solves the system noise problem.

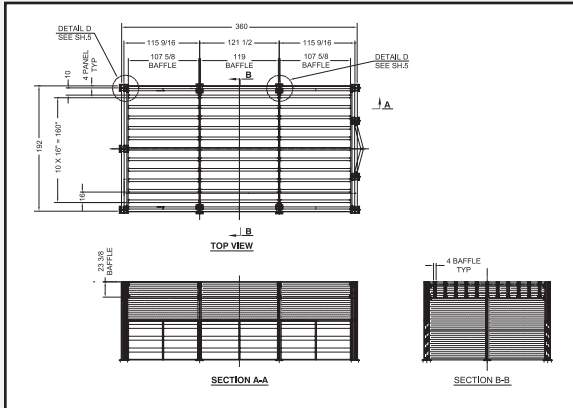

Considerations

- Equipment warranty
- Electrical/Building codes
- Equipment ventilation
- Noise ordinance
- Location of equipment relative to critical areas
- Maintenance access
- Structural issues - seismic, drainage, wind loading, footings, tie-ins, etc.

KINETICS OFFERS:

Proper Acoustical Design

Three and four-sided Model STL, acoustical barrier wall systems, allowing sufficient space between barrier/chiller as well as equipment and access doors as required. Add on VAL acoustical louvered skirt for ventilation. Add on VAR acoustical louvered roof system to redirect noise from critical areas, achieving maximum noise reduction at a very low pressure drop. Systems can be located on grade or rooftop.

Standard Products; Custom Engineered

Our knowledge and experience save you time and money. Modular units ship knocked-down for easy transport and quick field assembly. Product manufactured from galvanized steel or aluminum and can be factory powder-coated or field painted.

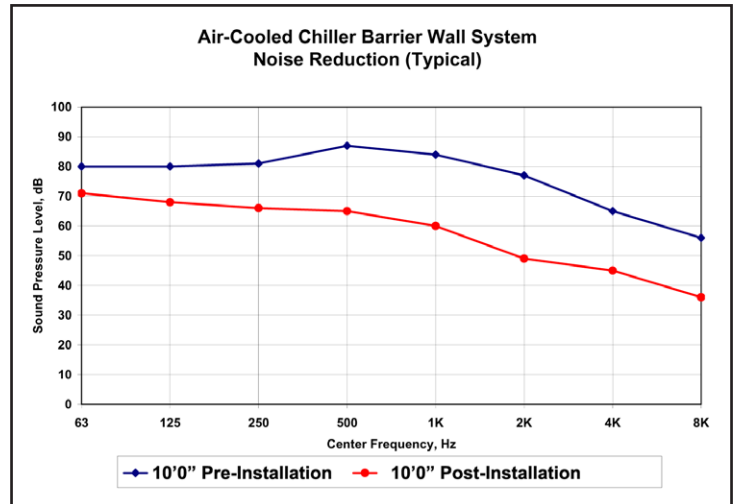

Walls (Reduction): 18-23 dBA
 Baffled Top (Reduction): 8-10 dBA
 $\Delta P(\text{Sys.}) = 0.10'' \text{ Wg}$

NOISEBLOCK™ STL AND HTL Panel Performance, Various Skin Types Sound Transmission Loss per ASTM E90

Model	Transmission Loss						
	125	250	500	1000	2000	4000	STC
NOISEBLOCK (STL)-2" (18s/22p)	17	23	34	47	55	57	37
NOISEBLOCK (STL)-2" (18s/22s)	19	25	35	48	56	60	39
NOISEBLOCK (STL)-4" (18s/22p)	21	28	39	48	56	58	40
NOISEBLOCK (STL)-4" (18s/22s)	24	32	41	51	60	66	44
NOISEBLOCK (HTL)-4" (16s/22p)	27	34	48	61	66	70	48
NOISEBLOCK (HTL)-4" (16s/22s)	27	39	59	68	67	72	52

NOTES

18s/22p - 18 gage solid outer skin and 22 gage perforated inner skin
 18s/22s - 18 gage solid outer skin and 22 gage solid inner skin
 16s/22p - 16 gage solid outer skin and 22 gage perforated inner skin
 16s/22s - 16 gage solid outer skin and 22 gage solid inner skin
 STL - Standard Transmission Loss
 HTL - High Transmission Loss



kineticsnoise.com
 sales@kineticsnoise.com
 1-800-959-1229