

NOTE:
 MODEL ESR TO PROVIDE CONTINUOUS SUPPORT OF UNIT WEIGHT WITH 4" TOP RAIL.

RESTRAINT AND ATTACHMENT DATA

TO ACHIEVE FULL RESTRAINT RATING, WELD EACH ESR PEDESTAL TO STRUCTURAL STEEL IN 3 PLACES (MIN.) AS NOTED. 1) A 6"x 0.25" WELD CENTERED ON THE OUTSIDE EDGE OF EACH PEDESTAL BASEPLATE. 2) & 3) TWO 6"x 0.25" WELDS WRAPPED AROUND EACH CORNER AT THE ENDS OF THE INSIDE EDGE WITH 3" OF WELD ON EACH END AND 3" ALONG THE INSIDE EDGE.

RESTRAINT RATING DATA (PER PEDESTAL)

AT STANDARD HEIGHT WITH NO CROSS BRACES
 WELDED ATTACHMENT
 HORIZONTAL - 3247 LB, VERTICAL - 8906 LB, COMBINED - 1164 LB
 BOLTED ATTACHMENT
 HORIZONTAL - 1547 LB, VERTICAL - 3984 LB, COMBINED - 1164 LB
 CROSS BRACE MOMENT RESISTANCE - 18000 IN LB PER PEDESTAL

ROOFTOP EQUIPMENT

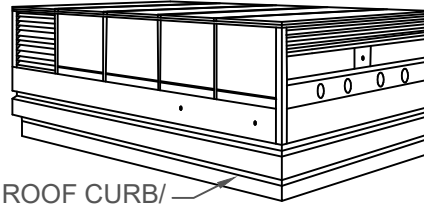

**ROOF CURB/
ISOLATION RAIL**

MODEL	SPRING CAPACITY (PER PEDESTAL) BY MODEL					
	RATED		SPRING			
	LOAD lb/kg	DEFL in/mm	FR. HT. in/mm	O.D. in/mm	COLOR	
				OUTER	INNER	
ESR-2-100	100/45	2.00/51	6.09/155	3.50/89	GRAY	
ESR-2-135	135/61	2.00/51	6.09/155	3.50/89	BEIGE	
ESR-2-185	185/84	2.00/51	6.09/155	3.50/89	BROWN	
ESR-2-225	225/102	2.00/51	6.09/155	3.50/89	GRAY	BROWN
ESR-2-250	250/113	2.00/51	6.09/155	3.50/89	BLUE	
ESR-2-375	375/170	2.00/51	6.09/155	3.50/89	BLUE	BROWN
ESR-2-500	500/227	2.00/51	6.09/155	3.50/89	GREEN	
ESR-2-625	625/283	2.00/51	6.09/155	3.50/89	GREEN	BROWN
ESR-2-750	750/340	2.00/51	6.09/155	3.50/89	BLACK	
ESR-2-875	875/397	2.00/51	6.09/155	3.50/89	BLACK	BROWN
ESR-2-995	995/451	2.00/51	6.09/155	3.50/89	ORANGE	
ESR-2-1120	1120/508	2.00/51	6.09/155	3.50/89	ORANGE	BROWN
ESR-2-1400	1400/635	2.01/51	6.09/155	3.50/89	ORANGE	GREEN
ESR-2-1600	1600/726	2.00/51	6.09/155	3.50/89	ORANGE	GREEN
ESR-2-1975	1975/896	1.98/50	6.09/155	3.50/89	RED	GREEN

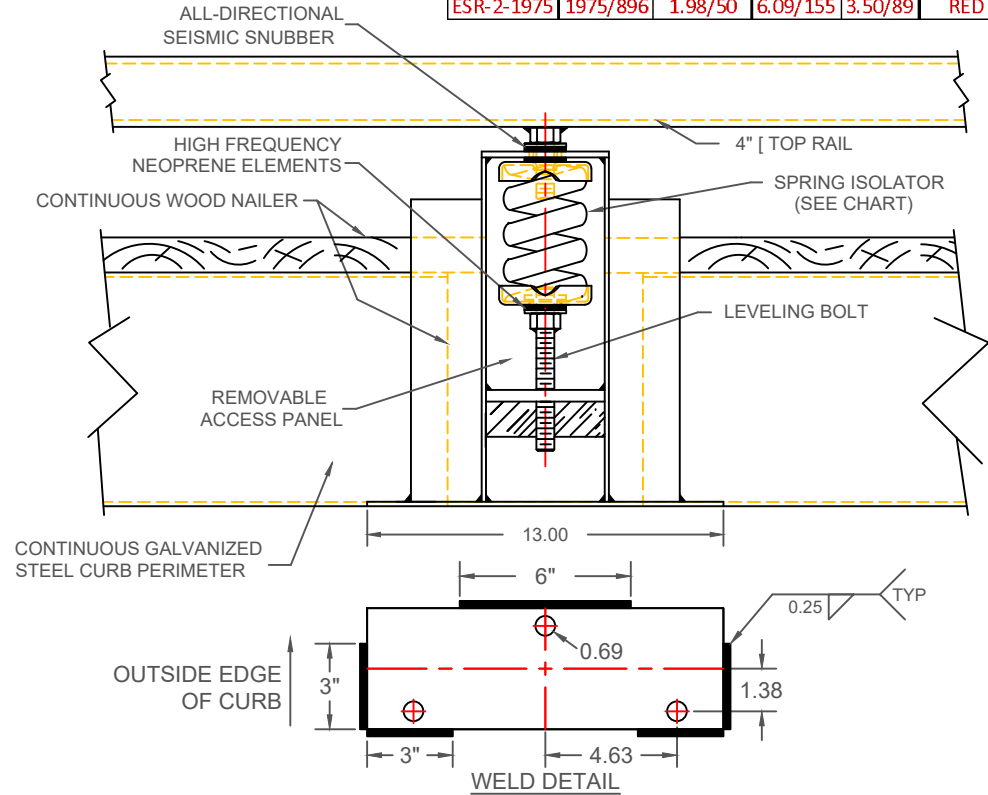
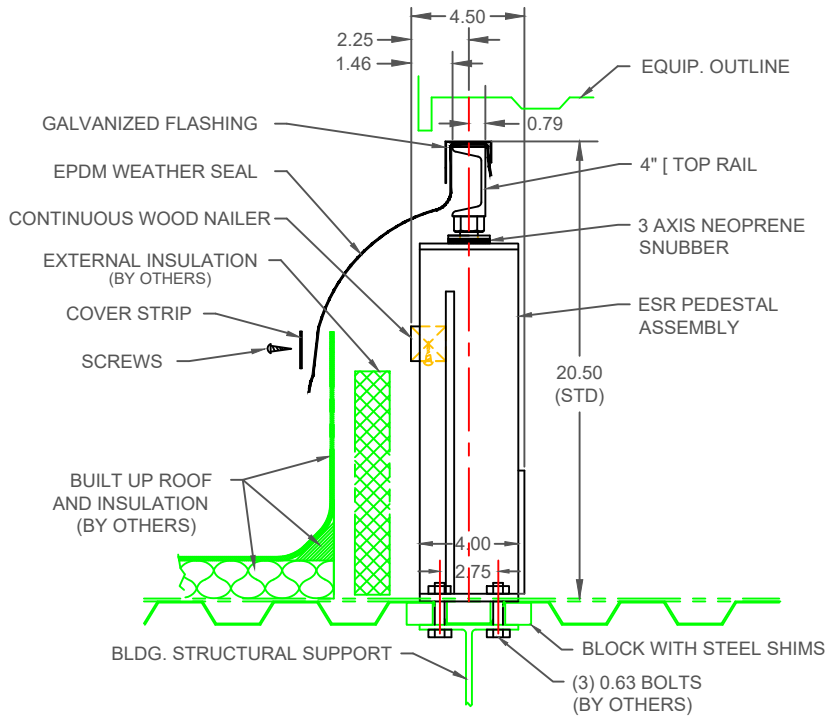

SPECIFICATIONS

- SPRING ISOLATORS ARE COMPUTER SELECTED AND LOCATED TO NOMINALLY PROVIDE THE RATED STATIC DEFLECTION.
- SPRING ISOLATORS HAVE A MINIMUM Kx/Ky OF 1.2.
- SPRING ISOLATORS HAVE A TYPICAL OVERLOAD CAPACITY OF 50%.
- SPRING ISOLATORS ARE SAFE AT SOLID LOADING.
- SPRING ISOLATORS ARE POWDER COATED.



TITLE
ESR-2 ISOLATION CURB

LAST DATE
 REVISED
08/05/19

REVISED BY
BB

DRAWING NO.
S-89.200-1A